



NEW HORIZONS SPAIN

+34 633 51 58 38

info@nhspain.com

IM16221H



Apartment in Estepona

€329,000

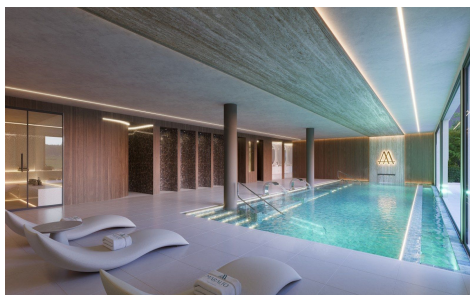

1



1



60m²



15m²



Elevated Living Between the Sea and the Mountains Experience the balance of coastal charm and urban convenience. Located in the rising Las Mesas district of Estepona, this residential complex offers a lifestyle defined by light, breeze, and panoramic views. The Location - Urban Heart & Natural Soul Positioned within Estepona's urban core, you are moments away from the essentials: Connectivity: Walking distance to the Marina, the Andalusian Old Town, and Parque de las Mesas. Convenience: Easy access to schools, sports centres, supermarkets, and transport links. The Coast: Over 20 km of Blue Flag beaches and a Mediterranean climate that invites outdoor living year round. Architecture and Resort Amenities The building design features flowing curves... (Ask for

www.nhspain.com